



PLATEWHEELS 5 x 2.5 mm for roller chains in compliance with DIN 8187 - ISO/R 606

## 5 x 2.5 mm

### PLATEWHEEL

|                                  |     |    |
|----------------------------------|-----|----|
| Tooth radius $r_3$               | 5   | mm |
| Radius width $\overset{\sim}{C}$ | 0,6 | mm |
| Plate tooth width $B_1$          | 2,3 | mm |

### CHAIN

|                      |     |    |
|----------------------|-----|----|
| Pitch                | 5   | mm |
| Inner width          | 2,5 | mm |
| Roller $\varnothing$ | 3,2 | mm |

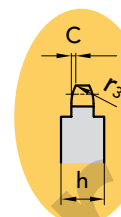
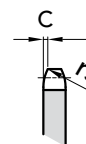
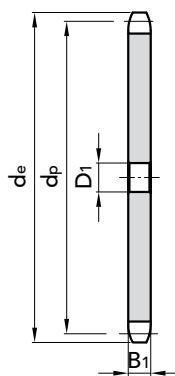

### SIMPLEX

| Z  | D <sub>1</sub> | d <sub>e</sub> | d <sub>p</sub> | P. NUMBER | kg.  | Z   | D <sub>1</sub> | d <sub>e</sub> | d <sub>p</sub> | P. NUMBER | kg.  |
|----|----------------|----------------|----------------|-----------|------|-----|----------------|----------------|----------------|-----------|------|
| 8  | 4              | 15,2           | 13,06          | 20105008  | 0,01 | 52  | 10             | 85,0           | 82,81          | 20105052  | 0,17 |
| 9  | 4              | 16,8           | 14,62          | 20105009  | 0,01 | 55  | 10             | 89,7           | 87,58          | 20105055  | 0,18 |
| 10 | 4              | 18,3           | 16,18          | 20105010  | 0,01 | 56  | 10             | 91,3           | 89,17          | 20105056  | 0,19 |
| 11 | 5              | 19,9           | 17,75          | 20105011  | 0,01 | 57  | 10             | 92,9           | 90,76          | 20105057  | 0,20 |
| 12 | 5              | 21,5           | 19,32          | 20105012  | 0,01 | 58  | 10             | 94,5           | 92,35          | 20105058  | 0,20 |
| 13 | 5              | 23,0           | 20,89          | 20105013  | 0,01 | 59  | 10             | 96,1           | 93,94          | 20105059  | 0,21 |
| 14 | 5              | 24,6           | 22,47          | 20105014  | 0,01 | 60  | 10             | 97,7           | 95,53          | 20105060  | 0,23 |
| 15 | 5              | 26,2           | 24,04          | 20105015  | 0,01 | 62  | 12             | 100,9          | 98,72          | 20105062  | 0,24 |
| 16 | 6              | 27,8           | 25,63          | 20105016  | 0,01 | 64  | 12             | 104,1          | 101,90         | 20105064  | 0,27 |
| 17 | 6              | 29,4           | 27,20          | 20105017  | 0,01 | 65  | 12             | 105,6          | 103,49         | 20105065  | 0,28 |
| 18 | 6              | 30,9           | 28,79          | 20105018  | 0,01 | 66  | 12             | 107,2          | 105,08         | 20105066  | 0,31 |
| 19 | 6              | 32,5           | 30,38          | 20105019  | 0,01 | 70  | 12             | 113,6          | 111,44         | 20105070  | 0,36 |
| 20 | 6              | 34,1           | 31,96          | 20105020  | 0,01 | 75  | 12             | 121,6          | 119,40         | 20105075  | 0,37 |
| 21 | 8              | 35,7           | 33,54          | 20105021  | 0,01 | 76  | 12             | 123,1          | 120,99         | 20105076  | 0,41 |
| 22 | 8              | 37,3           | 35,13          | 20105022  | 0,02 | 80  | 12             | 129,5          | 127,35         | 20105080  | 0,46 |
| 23 | 8              | 38,9           | 36,72          | 20105023  | 0,02 | 85  | 14             | 137,5          | 135,31         | 20105085  | 0,52 |
| 24 | 8              | 40,5           | 38,30          | 20105024  | 0,02 | 90  | 14             | 145,4          | 143,27         | 20105090  | 0,58 |
| 25 | 8              | 42,0           | 39,89          | 20105025  | 0,02 | 95  | 14             | 153,4          | 151,22         | 20105095  | 0,65 |
| 26 | 8              | 43,6           | 41,48          | 20105026  | 0,02 | 100 | 14             | 161,3          | 159,18         | 20105100  | 0,79 |
| 27 | 8              | 45,2           | 43,07          | 20105027  | 0,02 | 114 | 14             | 183,6          | 181,46         | 20105114  | 0,85 |
| 28 | 8              | 46,8           | 44,65          | 20105028  | 0,03 | 120 | 14             | 193,2          | 191,01         | 20105120  | 0,95 |
| 30 | 8              | 50,0           | 47,83          | 20105030  | 0,03 | 125 | 14             | 201,1          | 198,96         | 20105125  | 1,03 |
| 32 | 8              | 53,2           | 51,01          | 20105032  | 0,03 |     |                |                |                |           |      |
| 33 | 8              | 54,8           | 52,60          | 20105033  | 0,04 |     |                |                |                |           |      |
| 34 | 8              | 56,3           | 54,19          | 20105034  | 0,04 |     |                |                |                |           |      |
| 35 | 8              | 57,9           | 55,78          | 20105035  | 0,04 |     |                |                |                |           |      |
| 36 | 8              | 59,5           | 57,37          | 20105036  | 0,04 |     |                |                |                |           |      |
| 37 | 8              | 61,1           | 58,96          | 20105037  | 0,05 |     |                |                |                |           |      |
| 38 | 8              | 62,7           | 60,54          | 20105038  | 0,05 |     |                |                |                |           |      |
| 40 | 8              | 65,9           | 63,73          | 20105040  | 0,05 |     |                |                |                |           |      |
| 42 | 8              | 69,1           | 66,91          | 20105042  | 0,06 |     |                |                |                |           |      |
| 44 | 8              | 72,2           | 70,09          | 20105044  | 0,07 |     |                |                |                |           |      |
| 45 | 8              | 73,8           | 71,68          | 20105045  | 0,07 |     |                |                |                |           |      |
| 46 | 8              | 75,4           | 73,27          | 20105046  | 0,07 |     |                |                |                |           |      |
| 48 | 8              | 78,6           | 76,45          | 20105048  | 0,08 |     |                |                |                |           |      |
| 50 | 8              | 81,8           | 79,63          | 20105050  | 0,08 |     |                |                |                |           |      |

From Z.52 the width of the disk wheel increased to  $h = 4\text{mm}$

MATERIAL **FE / C45**

Ask for specific needs.

CAD drawings available on our site  
[www.chiaravalli.com](http://www.chiaravalli.com)

Quantity, availability and prices  
 on B2B Chiaravalli

